



SWIFT

Holiday Homes



Your Home Anywhere



Welcome to Swift

UK's No.1

brand for

leisure

vehicles

We are the UK's largest manufacturer of touring caravans, motorhomes and holiday homes. We've grown from simple foundations back in 1964, when our founder Ken Smith built his first touring caravan, to become the UK's number one leisure vehicle brand.

Our philosophy is to build leisure vehicles that are at the heart of your holiday, whether that be nestled in the countryside or by the sea, searching out active pursuits or simply enjoying a quieter pace of life. With a lifetime of memories waiting to be made, it's time to find your ultimate holiday home.



Contents

Five steps to holiday home ownership	5	Ardennes	30
Find your happy place	6	Provence	34
Trends and design insights	7	Loire	38
Why Swift?	8	Atlantique	42
The Swift Difference	9	Royan	46
Montreal	10	Holiday homes at a glance	50
Vendee	14	Exterior finishes	52
Margaux	18	Holiday home dimensions	54
Bordeaux	22	Swift approved partners	55
Morlaix	26		

Get away from it all

At Swift, we want your holiday home to become your sanctuary - a place where you can truly unwind, relax, and let the stresses of everyday life melt away. Our unwavering dedication to innovation ensures that we deliver products that are not only luxurious but also practical. With each stay at your holiday home, you're not just enjoying a holiday, but crafting cherished memories that will last a lifetime.



Five steps to holiday home ownership

Your very own holiday home opens up endless opportunities for breaks away and making memories for years to come. But knowing where to start can be overwhelming; what aspects do you need to consider? What holiday home is for you? How do you choose your favourite holiday park? We know the questions can feel exhausting, so we've put together a handy guide to get you started on your quest to find your dream holiday home or lodge at your perfect location.

Step One

Is holiday home ownership right for me?

If you're seeking regular breaks throughout the year along with the freedom to come and go as you please, then holiday home ownership could be right for you. Ownership gives you the opportunity to spend quality time with your friends and family, as well as the opportunity to pursue and enhance your favourite hobbies – whether that be walking or cycling, an interest in wildlife and nature or just simply to enjoy the peace that a regular escape can offer.

Step Two

Finding your dream park

This is perhaps the most important step, so we encourage you to really take your time and be very thorough with your research. Getting this step right will ensure you years of happiness.

We've created a destinations page showing highlights of top UK destinations:

swiftholidayhomes.co.uk/destinations/

Step Three

Visiting the parks

Once you've established everything you need from a holiday home, create a shortlist of your favourite parks, so you can visit each one to help you choose the one that's right for you.

Step Four

Choosing your holiday home

At Swift, we dedicate a lot of time to fully understand your holidays and what makes them special. Our holiday homes are made with the finest materials from leading suppliers, and with space at a premium, storage design is an important aspect. Both finish and practicality is of utmost importance, and this combination ensures Swift remains a popular choice.

You'll need to consider the level of specification you want – at the top end, features such as a dishwasher and a wine cooler can come as standard, while some of our holiday homes might offer these as an optional extra. So, take your time to figure out what additions you need to make your holidays special.

Step Five

What happens now?

Now you've chosen your holiday home, your hard work is done, and you just need to wait for the keys! Your park and dealer will work together to ensure a smooth handover, taking care of the transport, siting, connections and commissioning. When you pick up your keys, your park will typically provide a full handover, taking you through your new holiday home to ensure you are confident with how everything works and answer any questions you may have.



Finding your happy place

Choosing your perfect location is one of the most important decisions you'll make when purchasing your holiday home. But with so many beautiful locations across the UK and Ireland, it can be tricky to pin down your ultimate destination. From speaking to customers, we believe that choosing a holiday park within a 2-3 hour drive is optimum for ensuring you can make the most of your holiday home.

For holiday inspiration, we've put together a selection of videos on our website showcasing key highlights from different regions. We've also done the hard work, so you don't have to, and have collated a list of holiday parks across the UK and Ireland, with contact details and website information so you can book a visit. For more information visit: [swiftholidayhomes.co.uk/destinations/](https://www.swiftholidayhomes.co.uk/destinations/)



Expertly designed and crafted



Jessie Milburn
Design Lead

We follow research insights and trends to keep ahead of the designs that appeal to both today's and tomorrow's customers, while also taking the time to understand what design aspects are important to you and your holiday lifestyle.

Today's trends involve a higher degree of ecological and environmental considerations, and at Swift, we share these values in our design and manufacturing decisions. We aim to replicate the natural world in both colour and material choices across all of our products.



Keeping on top of the trends through observation and research, we have seen a change in how our holiday homes are now used. Today, leisure and work can comfortably mix, and our holiday homes become more than just a place to relax and unwind. They now present an opportunity for home working, which creates a new design vision and consideration for our holiday homes and lodges of the future.



Why Swift?

There's no better feeling than stepping into your holiday home for a relaxing getaway, so we do everything possible to make that feeling last for years to come.

We pride ourselves on applying superior manufacturing quality to everything we produce, giving you the confidence that your investment is protected and built to last.

With the comfort of total assurance in your purchase, you can get on with the important things in life - creating lasting memories. And prioritising your peace of mind, we offer outstanding warranties, including a 3-year Manufacturer Supersure Warranty, 5-year Structural Warranty and 10-year Chassis Warranty.

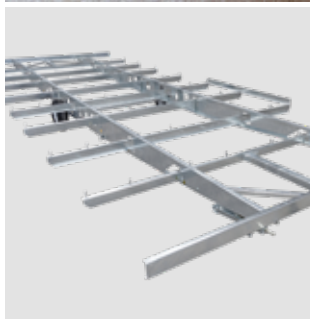
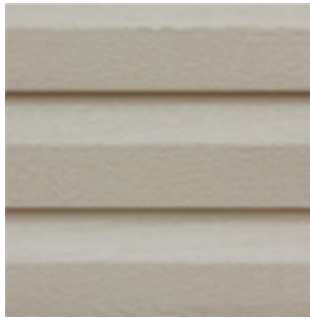

Exclusive Duvalay™ mattresses

All beds feature indulgent Duvalay™ mattresses for the best nights' sleep

Bonded exterior walls

'Sandwich' construction walls provide a more rigid exterior, bonded with insulation in the middle

Electrical and USB sockets

Stay connected with electrical and USB sockets in selected areas keeping everything charged

Stain resistant carpets

With stain resistant carpets, there's no need to waste your precious holiday time scrubbing

Fully galvanised chassis

Protecting your holiday home, Swift's robust, fully galvanised or I Beam chassis resist corrosion and is warrantied for 10 years

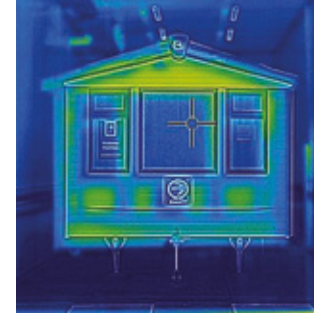

High thermal efficiency

Enjoy outstanding thermal efficiency, proven by environmental chamber testing and calculations

Integrated fridge freezers

Integrated fridge freezers are included across all ranges to maintain a sleek, uncluttered look (except Royan)

Externally vented extractors

Keep your holiday home fresh and dry with externally vented extractors, preventing damp and odours

LED ceiling lights

Benefitting the environment and your pocket, bright, low energy LED lighting is included throughout

Integrated microwaves

Optimising valuable work surface space, all Swift Holiday Homes feature integrated microwaves*

*Except Royan



The Swift Difference

Roof trusses

For accuracy, strength and reliability, all Swift Holiday Homes have prefabricated roof trusses. The resulting roof strength meets Grade B snow loading (capable of carrying half a metre of settled snow), while glass wool insulation provides excellent thermal efficiency.

Wall construction

Our bonded 'sandwich' exterior wall construction gives greater structural strength. The walls are made in modules and are clad with aluminium CanExel. Each module consists of a robust timber frame, battened out and filled with insulation and a plywood inner skin.



3-Year Supersure Warranty

Your holiday home has 3-year cover for all parts and fittings (other than the structural exterior).

This includes items like:

- Freestanding furniture
- Kitchens
- Showers
- Sanitaryware
- Sockets and switches
- Interior doors and integrated furniture
- Gutter and fall pipes



5-Year Structural Warranty

Your holiday home has a 5-year Structural Warranty and Swift will repair (or, at its option, replace) any defects with the structural integrity of the home that come to light and are notified to Swift during the warranty period.

The Structural Warranty covers any defect with the seams of the home, including water ingress through any permanently sealed seam joints and also items like:

- External doors
- uPVC windows
- Roof, walls and ceilings
- Carpets



10-Year Chassis Warranty

Your holiday home has a fully galvanised chassis with a 10-year Chassis Warranty, subject to maintenance. Swift will repair (or, at its option, replace) any defects with the chassis that come to light during this period, but only for as long as the home belongs to its first owner.

All warranties start from the date an approved Swift Group dealer or park operator transfers the unit to its first owner and are subject to conditions, terms and exclusions. For full details see www.swiftholiday-homes.co.uk/owners

Double Glazing

Heat-reflecting 'Thermaglas' double glazing, with a 16mm air space, is fitted as standard or as an option on our holiday home ranges.

Chassis

Swift only specify a fully galvanised chassis as standard. What's more, every Swift holiday home comes with a 10-year anti-corrosion warranty.

Floor construction

The flooring in Swift Holiday Homes is constructed from timber joists. Class-leading 80mm glass wool insulation is placed between the joists and the floor is covered with a breathable membrane and a waterproof finish for durability.

Construction and thermal efficiency

Swift's Holiday Home range is built to BS EN 1647, and meets the National Caravan Council (NCC) Structural Thermal Rating Scheme for Caravan Holiday Homes.



Safety comes first

All our holiday homes are built in accordance with British and European standards and are audited against these build standards by the National Caravan Council (NCC).





Montreal



Step inside the Montreal, our first twin unit Holiday Home, boasting a stunning farmhouse aesthetic. Designed for families in mind, the Montreal presents a spacious interior and features a practical hallway, ideal for managing muddy boots and pets. With its neutral, on trend design, the Montreal provides the perfect canvas for you to incorporate your own personal style.

Model size	Bedrooms	Main bed	Twin beds	Rear twin beds
40' x 20'	2	2.02m x 1.53m (6'8" x 5'0")*	1.83m x 0.92m (6'0" x 3'0")	N/A
41' x 20'	3	2.02m x 1.53m (6'8" x 5'0")	1.83m x 0.92m (6'0" x 3'0")	1.83m x 0.92m (6'0" x 3'0")

*Estimate

Features at a glance

Along with all the Swift key features on page 8, Montreal comes with many desirable extras including:



Twin unit



Front sliding door



Zip and link mattress



4 burner gas hob



Walk-in dressing room



Vanity area with mirror





Montreal full features

EXTERIOR

- Protech galvanised chassis with finish warranted for ten years
- **NEW** 20ft wide twin unit with 10ft and 10ft split
- Bonded sandwich exterior wall construction for greater strength
- Coated steel pantile roof
- Distinctive pre-coated 'folded' steel bargeboards with LED lighting to front aspect
- Woodgrain textured 'Sandy Beige' aluminium cladding
- White uPVC windows with push-button security locks
- PVC gutters and down pipes
- Low energy exterior side light

INSULATION

- Thermaglas uPVC double glazing
- **NEW** improved thermal performance:
 - 25mm PIR insulation in floor
 - 200mm Superglass insulation in roof
 - 60mm EPS Insulation
 - Lagged underfloor pipes

INTERIOR

- 'Farmhouse' soft furnishing scheme
- 30kW gas combi-boiler central heating and hot water system
- Luxury carpet with underlay throughout lounge and bedrooms
- **NEW** 'Provenza' grey toned vinyl flooring in kitchen/dining/ bathrooms
- 'Tobacco Halifax' oak, 'Stone grey' and 'Truffle brown' woodgrain furniture
- Low energy LED lighting throughout
- USB sockets
- Double electric sockets throughout
- **NEW** 'White Ash' wood interior doors
- Front sliding door to dining area

ENTRANCE HALL

- Entrance utility area with built in boiler cupboard and storage cupboards in 'Stone Grey' with 'Aerial' knob handles. Feature coat hooks area with shelving in 'Tobacco Halifax' oak, upholstered 'Aston' bench and shoe rack
- Interior door to living area
- Hardwearing entrance floor matt

LOUNGE

- Wide full height aspect window
- Décor feature wall in 'Espresso'
- Freestanding 'Valentina' two-seater and three-seater sofas with scatter cushions
- 'Tobacco Halifax' oak coffee table
- 'Tobacco Halifax' oak TV unit and storage with 'Truffle Brown' feature panel and overhead decorative shelf
- 'Pewter' curtain poles with lined curtains

KITCHEN / DINING

- Shaker style kitchen doors in 'Stone Grey' with 'Pewter' 'Aerial' knob and 'Twister D' handles
- 30mm 'Tobacco Halifax' oak worktops with matching splashback
- 'Domapp' glass fronted oven and grill with electronic ignition
- Four-burner gas hob with electronic ignition
- Externally vented cooker hood
- 'Manhattan' chrome tap, stainless steel sink bowl and drainer
- Integrated microwave oven (800w)*
- Integrated fridge freezer
- 'Tobacco Halifax' oak freestanding dining table with 'Truffle Brown' legs.
- Six 'Freyja Bis' chairs with 'Truffle Brown' legs and 'Aston' cushion pads

MAIN BEDROOM

- King-size double bed in main bedroom with lift up storage
- Deeper and more luxurious Aurora Duvalay™ mattress with Crib 5 rated fabric, and featuring 'S-Line' pocket springs and a high-density foam layer for increased and lasting comfort
- Bedside cabinets in 'Tobacco Halifax' oak with matching feature headboard
- Decorative feature wall in 'Espresso'
- Large walk in dressing room and vanity area. Open robe hanging area with four 'Stone grey' draws and 'Tobacco Halifax' oak shelf. Vanity area in 'Tobacco Halifax' Oak with large mirror, shelving and upholstered footstool.
- TV position
- Curtain poles with blackout lined curtains
- Good provisions of double sockets

BEDROOMS

- Deeper and more luxurious Aurora Duvalay™ mattress with Crib 5 rated fabric, and featuring 'S-Line' pocket springs and a high-density foam layer for increased and lasting comfort (3ft wide single beds) for all twin rooms
- Zip and link mattress to make super kingsize bed in twin bedroom
- Bedside cabinets in 'Tobacco Halifax' oak with matching feature headboard
- Large open wardrobe in 'Tobacco Halifax' oak with matching vanity area, mirror and upholstered stool
- TV position
- Curtain poles with blackout lined curtains
- Good provisions of double sockets

BATHROOMS

- Jack and Jill bathroom with two entrance doors for private access from hallway and bedroom (2 bed model only)
- Shower cubicle with thermostatic shower in en suite
- **NEW** 1700mm Bath with shower above in main bathroom
- Vanity shelving in 'Tobacco Halifax' Oak with 'Stone Grey' feature panel
- Dual flush WC
- LED vanity spotlights
- Extractor fan in main bathroom

OPTIONS

- 'Environmental Green' exterior with 'Anthracite' window frames
- 'Sandy Beige' exterior with 'Anthracite' window frames
- CanExel in 'Mist Grey' with 'Anthracite' windows
- Deluxe pack – coffee table cubes, footstool, mirrors, picture and window voiles
- Washer dryer
- Integrated dishwasher
- Bluetooth® audio connection to lounge ceiling speakers
- Shaving socket in main bathroom

FLOOR PLANS

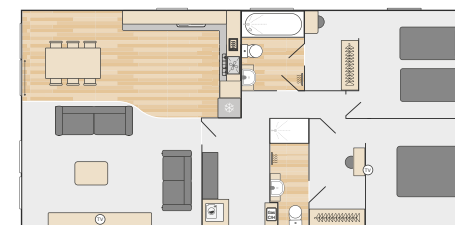

40' x 20' - 2 Bedroom

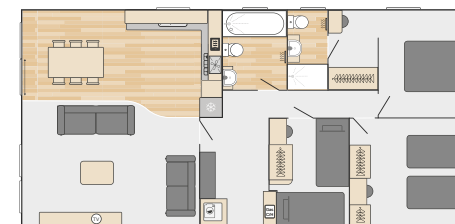

41' x 20' - 3 Bedroom

*The model fitted may differ from that shown in images, please check with supplying dealer or park.



Now comes with front double sliding door

Vendee

Step inside the Vendee, Swift's cosy country retreat and one of our most popular holiday homes. With its contemporary cottage feel, this premium holiday home is refreshed with Acanthium soft furnishings, enhancing the range's on-trend interiors. Enjoy the finer things in life with Vendee's luxurious details, ample space and plentiful storage.

Model size	Bedrooms	Main bed	Twin beds
40' x 12'	2	2.02m x 1.53m (6'8" x 5'0")	1.83m x 0.69m (6'0" x 2'3")



Features at a glance

Along with all the Swift key features on page 8, Vendee also comes with many desirable extras including:

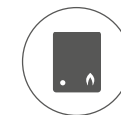

Central heating



Double glazing



Electric fire



5 Burner hob



Heated rail



USB sockets





Vendee full features

EXTERIOR

- Fusion galvanised chassis with finish warranted for ten years
- Bonded sandwich exterior wall construction for greater strength
- Coated steel pantile roof
- Distinctive pre-coated 'folded' steel bargeboards with LED lighting to front aspect
- Woodgrain textured 'Sandy Beige' aluminium cladding
- Front aspect sliding doors
- Anthracite uPVC windows with push-button security locks
- PVC gutters and down pipes
- Low energy exterior side light

INSULATION

- Excellent thermal performance:
 - Thermaglas uPVC double glazed windows and doors
 - 60mm insulation in floor
 - 90mm insulation in roof
 - 30mm insulation in walls
 - Lagged underfloor pipes

INTERIOR

- 7ft (2.13m) high ceilings at side walls
- 'Acanthium' soft furnishing scheme
- Luxury carpet with underlay
- Hardwearing vinyl flooring in 'Almeria' in kitchen/dining/bathroom(s)
- 'Nebraska Oak' woodgrain
- Gas combi-boiler central heating and hot water system with radiator thermostats
- Low energy LED lighting
- USB sockets
- Good provision of double electric sockets throughout

ENTRANCE HALLWAY

- Seat bench featuring coat hooks and shoe storage
- Large mirror and wall unit

LOUNGE

- Freestanding two-seater and three-seater sofas with scatter cushions
- Complementary footstool with storage
- TV unit with storage, TV provision and Sky TV cable for connection only to TV cabinet
- Additional high level TV point
- Contemporary 2kW electric Optiflame® stove feature fire with mirror over fireplace
- Contemporary framed colour wall pictures
- Central 'Tyler' copper effect pendant light feature
- White slatted wooden blinds
- Full height luxury curtains to front aspect

KITCHEN / DINING

- Integrated wine rack
- Florence dining table in 'Nebraska Oak'/'Painted Porcelain' with four Combo chairs
- Kitchen with country classic feel. Cupboards in 'Dakar' with 'Larch' woodgrain details and copper cup door and drawer handles
- Soft close drawers
- 'Belling' stainless steel oven
- Five-burner gas hob with central wok burner and electronic ignition
- Integrated externally vented silver extractor hood
- Integrated microwave oven (800w)*
- Integrated fridge and freezer
- 40mm 'Brown Mountain Larch' laminate worktops
- 'Brown Mountain Larch' splashbacks
- White resin bowl and drainer with copper effect tap

BATHROOM(S)

- Shower cubicle with thermostatic shower, topper and LED downlights in main bathroom and ensuite
- Dual flush WC with soft close toilet seat
- White heated towel rails
- Vanity storage unit with mirror above
- Additional storage cupboard
- Extractor fan in main bathroom and ensuite

BEDROOMS

- King-size double bed in main bedroom with lift up storage
- Deep and luxurious Aurora Duvalay™ mattress to all beds with Crib 5 rated fabric, and featuring 'S-Line' pocket springs and a high-density foam layer for increased and lasting comfort
- Padded headboard in main bedroom
- Ample storage with bedside units and over bed cupboards in the main bedroom
- Wall mounted bedside lights
- Dressing table with mirror, lighting and storage
- Window seat and TV panel with credenza drawer unit in main bedroom
- Nature inspired wall pictures
- TV sockets and Co-Ax to all bedrooms plus booster

OPTIONS

- Dishwasher or washer/dryer
- Freestanding three-seater sofa with fold out occasional bed, replacing standard three-seater
- 'Environmental Green' exterior with 'Anthracite' window frames
- Bluetooth® audio connection to lounge ceiling speakers
- Shaving socket in main bathroom
- Gazunda bed in twin bedroom for extra space (one bed stores under the other when not required)

FLOOR PLAN



40' x 12' - 2 Bedroom

*The model fitted may differ from that shown in images, please check with supplying dealer or park.



Margaux



Brand new for the 2025 season, the Margaux is designed to impress with its luxurious townhouse interior and modern vibe. Featuring a bright interior, highlighted by a full-height front aspect window and a stunning kitchen, equipped with integrated high-spec appliances, the Margaux is the perfect space for entertaining.

Features at a glance

Along with all the Swift key features on page 8, Margaux also comes with many desirable extras including:

Model size	Bedrooms	Main bed	Twin beds	Rear twin beds	Sofa bed
33' x 12'	2	1.91m x 1.53m (6'3" x 5'0")	1.83m x 0.69m (6'0" x 2'3") 1.76m x 0.69m (5'9" x 2'3")	N/A	1.80m x 1.12m (5'11" x 3'8")
35' x 12'	2	1.91m x 1.53m (6'3" x 5'0")	1.83m x 0.69m (6'0" x 2'3") 1.76m x 0.69m (5'9" x 2'3")	N/A	1.80m x 1.12m (5'11" x 3'8")
38' x 12'	2	1.91m x 1.53m (6'3" x 5'0")	1.83m x 0.69m (6'0" x 2'3") 1.76m x 0.69m (5'9" x 2'3")	N/A	1.80m x 1.12m (5'11" x 3'8")
38' x 12' ES	2	1.91m x 1.53m (6'3" x 5'0")	1.83m x 0.69m (6'0" x 2'3") 1.76m x 0.69m (5'9" x 2'3")	N/A	1.80m x 1.12m (5'11" x 3'8")
38' x 12'	3	1.91m x 1.37m (6'3" x 4'6")	1.83m x 0.69m (6'0" x 2'3") 1.76m x 0.69m (5'9" x 2'3")	1.83m x 0.69m (6'0" x 2'3")	1.80m x 1.12m (5'11" x 3'8")

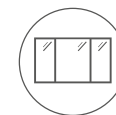

Front aspect window



Sofa bed



4 Burner hob



USB sockets



Vanity area with mirror



Wardrobe





Margaux full features

EXTERIOR

- Fusion galvanised chassis with finish warranted for ten years
- **NEW** thicker bonded sandwich exterior wall construction for strength and improved insulation
- Coated steel pantile roof
- Distinctive pre-coated 'folded' steel bargeboards with LED lighting to front aspect
- Woodgrain textured 'Sandy Beige' aluminium cladding
- Large front aspect windows
- White uPVC windows with push-button security locks
- PVC gutters and down pipes
- Low energy exterior side light

INSULATION

- **NEW** improved thermal performance:
 - Thermaglas uPVC double glazing
 - 80mm insulation in floor
 - 100mm insulation in roof
 - 60mm insulation in walls
 - Lagged underfloor pipes

INTERIOR

- 7ft (2.13m) high ceilings at side walls
- 'Town House' soft furnishing scheme
- Luxury carpet with underlay throughout lounge and bedrooms
- Gas combi-boiler central heating and hot water system with radiator thermostats
- **NEW** 'Provenza' vinyl flooring in kitchen/dining/ bathroom(s)
- 'Light grey' and **NEW** 'Indigo' furniture with 'Tobacco Halifax' oak woodgrains
- Low energy LED lighting throughout
- USB sockets
- Electric sockets throughout

LOUNGE

- Freestanding two-piece suite in 'Aston' with matching ottoman footstool and fold out occasional bed
- Décor wall board in 'Espresso'
- 'Indigo' shiplap feature wall accentuated by large round mirror
- 'Light Grey' wall unit and 'Tobacco Halifax' oak top with shelving and storage cupboards. Matching freestanding TV unit with drawer
- TV point with Co-Ax and 240V socket for wall or stand mounted TV's
- 'Pewter' curtain poles with lined curtains
- Large Town House framed wall picture

KITCHEN/DINING

- **NEW** stylish 'U' shaped kitchen units with 'Aerial' knobs and soft close doors and drawers in 'Indigo Blue' with upper doors in 'Light Grey' and matching cornice
- 'Levanto' 40mm marble effect worktops with white tile effect splashback
- 'Domapp' glass fronted oven and grill with electronic ignition
- Four-burner gas hob with electronic ignition
- **NEW** discrete externally vented hob extractor fan
- 'Pewter' brushed steel tap and white resin bowl with drainer
- Integrated microwave oven (800w)*
- **NEW** dual thermostat integrated fridge/freezer
- 'Julieta' feature pendant light fittings above central worktop
- Oval 'Levanto' marble effect dining table
- Upholstered dining chairs in 'Turmeric'
- Roller blind in 'Carnival Taupe'

BATHROOM(S)

- **NEW** large shower cubicle with glass sliding door with black thermostatic shower with topper in main bathroom
- Dual flush WC
- White tile effect splashback
- LED vanity spotlights
- Extractor fan in main bathroom

BEDROOMS

- Double bed in main bedroom with lift up storage (king-size in 35'x12' 2B, 38' x12' 2B & 38x12 2B ES). Bed surround in 'Tobacco Halifax' oak with padded headboard in 'Lovely Ivory'
- Deep and luxurious Aurora Duvalay™ mattress to all beds with Crib 5 rated fabric, and featuring 'S-Line' pocket springs and a high-density foam layer for increased and lasting comfort
- 'Espresso' feature wall with 'Indigo' shiplap panelling in main bedroom
- Bedside cabinets in light grey with 'Tobacco Halifax' oak table top
- Large double wardrobe in 'Light Grey' with matching cornice and feature shelving in 'Tobacco Halifax' oak (main bedroom)
- 'Pasteri' bedside reading wall lights (main bedroom)
- Twin beds with 'Tobacco Halifax' oak bed surround and feature wall with padded fabric headboards in 'Santiago Jet' and 'Plush Navy' and **NEW** wall down lights (twin room)
- Overhead locker to the ceiling in 'Light Grey' with matching cornice. Feature shelving in 'Tobacco Halifax' oak (twin room)
- Large wardrobe in 'Light Grey' and vanity area with mirror in 'Tobacco Halifax' oak (twin room)
- TV sockets & Co-Ax to all bedrooms plus booster
- USB points

OPTIONS

- Front aspect sliding door
- 'Environmental Green' exterior with 'Anthracite' window frames
- 'Sandy Beige' exterior with 'Anthracite' window frames
- Bluetooth® audio connection to lounge ceiling speakers
- Integrated slim-line dishwasher
- Shaving socket in main bathroom
- Contemporary 2kw Voltino fire with flame effect and remote control
- Gazunda bed in all twin bedrooms for extra space (one bed stores under the other when not required)

FLOOR PLANS

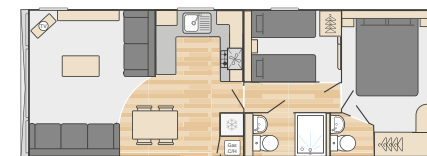

33' x 12' - 2 Bedroom

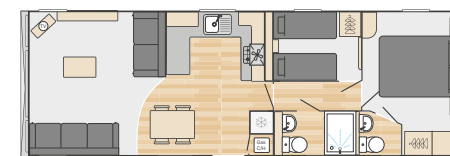

35' x 12' - 2 Bedroom

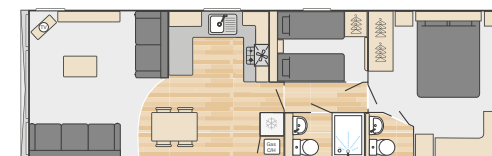

38' x 12' - 2 Bedroom

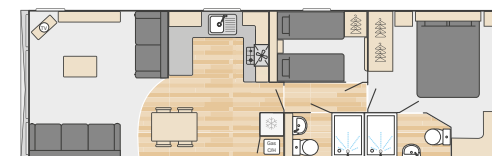

38' x 12' ES - 2 Bedroom

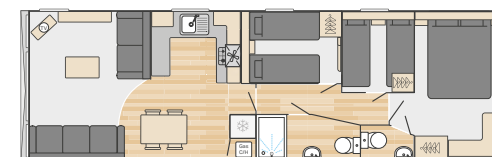

38' x 12' - 3 Bedroom

*The model fitted may differ from that shown in images, please check with supplying dealer or park.



Bordeaux

Well-appointed and stylish, Bordeaux is available in a choice of two or three bedrooms, offering contemporary accommodation for the whole family.

Model size	Bedrooms	Main bed	Twin beds	Rear twin beds	Sofa bed
33' x 12'	2	1.91m x 1.37m (6'3" x 4'6")	1.83m x 0.69m (6'0" x 2'3")	N/A	1.80m x 1.12m (5'11" x 3'8")
35' x 12'	2	1.91m x 1.53m (6'3" x 5'0")	1.83m x 0.69m (6'0" x 2'3")	N/A	1.80m x 1.12m (5'11" x 3'8")
38' x 12'	2	1.91m x 1.53m (6'3" x 5'0")	1.83m x 0.69m (6'0" x 2'3")	N/A	1.80m x 1.12m (5'11" x 3'8")
38' x 12' ES	2	1.91m x 1.53m (6'3" x 5'0")	1.83m x 0.69m (6'0" x 2'3")	N/A	1.80m x 1.12m (5'11" x 3'8")
38' x 12'	3	1.91m x 1.37m (6'3" x 4'6")	1.83m x 0.69m (6'0" x 2'3")	1.83m x 0.61m (6'0" x 2'0")	1.80m x 1.12m (5'11" x 3'8")



Features at a glance

Along with all the Swift key features on page 8, Bordeaux also comes with many desirable extras including:



Large windows



TV points



Sofa bed



USB sockets



Overbed storage



4 burner hob





Bordeaux full features

EXTERIOR

- Fusion galvanised chassis with finish warrantied for ten years
- Bonded sandwich exterior wall construction for greater strength
- Coated steel pantile roof
- Distinctive pre-coated 'folded' steel bargeboards with LED lighting to front aspect
- Woodgrain textured 'Sandy Beige' aluminium cladding
- Large front aspect windows
- White uPVC windows with push-button security locks
- PVC gutters and down pipes
- Low energy exterior side light

INSULATION

- Thermaglas uPVC double glazing
- **NEW** improved thermal performance:
 - 60mm insulation in floor
 - 80mm insulation in roof
 - 30mm insulation in walls
 - Lagged underfloor pipes

INTERIOR

- 7ft (2.13m) high ceilings at side walls
- 'Sousel' soft furnishing scheme
- Gas combi-boiler central heating and hot water system with radiator thermostats
- Luxury carpet with underlay
- Laminate effect vinyl flooring in kitchen/dining/ bathroom(s)
- 'Nebraska Oak' woodgrain
- Low energy LED lighting throughout
- Stylish 'Pronto Gold' matt handles throughout
- USB sockets
- Electric sockets throughout

LOUNGE

- Freestanding two-piece suite with fold-out occasional bed and scatter cushions
- Freestanding TV unit with drawer
- Additional wall mounted TV position suitable for 50" TV (in place of mirror)
- 2 x TV points with Co-Ax and 240V socket
- Lounge wall unit with two doors and central shelf
- Coffee table with two upholstered cylindrical stools underneath
- Larger mirror with gold frame with TV Socket behind for wall mounted TVs
- Framed mirror

KITCHEN / DINING

- 'Thetford Cocina' glass fronted oven, grill and electronic ignition with improved door function, higher temperatures, burner rating and heat-up times
- Four-burner gas hob with electronic ignition
- Discrete externally vented extractor fan
- Integrated microwave oven (800w)
- Integrated fridge and freezer
- Stylish kitchen units with soft-close doors and drawers in 'Riverstone Supermatt' with upper doors in 'Light Grey' perfect touch
- 40mm 'Levanto Marble' laminate worktops with upstands
- 'Steam Punk' pendant light fittings above central worktop
- Brass-effect tap with porcelain handles and white resin bowl with drainer
- White tile-effect splashback
- Dining table with 'Toulouse' wood-effect top
- Four 'Rochelle' dining chairs in 'Riverstone' (two additional folding chairs in three-bed models)
- Roller blind in 'Carnival Taupe'

BATHROOM(S)

- Large shower cubicle with glass sliding door and thermostatic shower with topper in main bathroom
- Dual flush WC
- Acrylic splashback with green glass look
- LED vanity spotlights
- Extractor fan in main bathroom

BEDROOMS

- Double bed in main bedroom with lift-up storage (king-size in 35'x12' 2B & 38' x12' 2B)
- Deep and luxurious Aurora Duvalay™ mattress to all beds with Crib 5 rated fabric, and featuring 'S-Line' pocket springs and a high-density foam layer for increased and lasting comfort
- Padded headboard(s)
- Bedside cabinets with 'Jackson Pine' inset panel and overbed storage
- Under-locker LED strip lights
- Vanity area with mirror and socket in main bedroom
- Brass-effect curtain poles
- TV sockets & Co-Ax to all bedrooms plus booster
- USB points in twin rooms

OPTIONS

- Front aspect sliding door
- Integrated slim-line dishwasher
- 'Environmental Green' exterior with 'Anthracite' window frames
- 'Sandy Beige' exterior with 'Anthracite' window frames
- Bluetooth® audio connection to lounge ceiling speakers
- Shaving socket in bathroom
- Gazunda bed in all twin bedrooms for extra space (one bed stores under the other when not required)

FLOOR PLANS

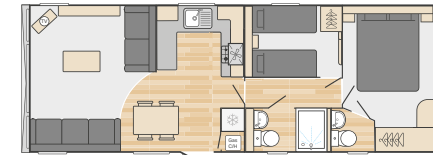

33' x 12' - 2 Bedroom

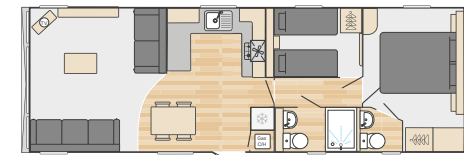

35' x 12' - 2 Bedroom

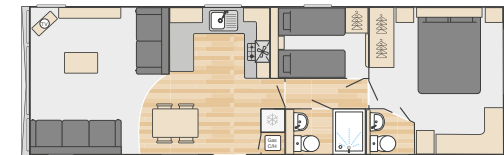

38' x 12' - 2 Bedroom

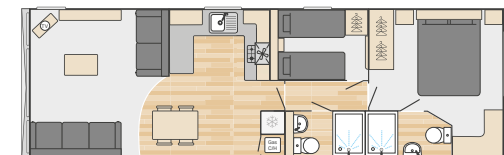

38' x 12' ES - 2 Bedroom

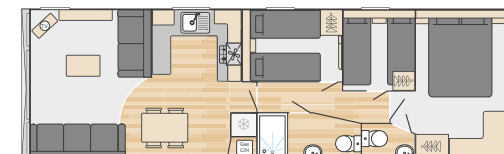

38' x 12' - 3 Bedroom

*The model fitted may differ from that shown in images, please check with supplying dealer or park.



Morlaix

Discover the Morlaix – a brand new home for the 2025 season, boasting a charming farmhouse interior and a cosy ambiance throughout. With neutral tones accented by 'Tobacco Halifax Oak' woodgrain features, this stylish holiday home is right on trend, providing the perfect retreat for the whole family.



Features at a glance

Along with all the Swift key features on page 8, Morlaix comes with many desirable extras including:



Full window



Spacious L-Shaped sofa



4 Burner hob



USB sockets



Wardrobe



Vanity area with mirror

Model size	Bedrooms	Main bed	Twin beds	Rear twin beds	Sofa bed
36' x 12'	2	1.91m x 1.53m (6'3" x 5'0")	1.83m x 0.69m (6'0" x 2'3") 1.76m x 0.69m (5'9" x 2'3")	N/A	1.80m x 1.12m (5'11" x 3'8")
38' x 12'	2	1.91m x 1.53m (6'3" x 5'0")	1.83m x 0.69m (6'0" x 2'3") 1.76m x 0.69m (5'9" x 2'3")	N/A	1.80m x 1.12m (5'11" x 3'8")
40' x 12' ES	3	1.91m x 1.53m (6'3" x 5'0")	1.83m x 0.69m (6'0" x 2'3") 1.76m x 0.69m (5'9" x 2'3")	1.83 x 0.69 (6'0" x 2'3")	1.80m x 1.12m (5'11" x 3'8")





Morlaix full features

EXTERIOR

- Fusion galvanised chassis with finish warranted for ten years
- Bonded sandwich exterior wall construction for greater strength
- Coated steel pantile roof
- Distinctive pre-coated 'folded' steel bargeboards with LED lighting to front aspect
- Woodgrain textured 'Sandy Beige' aluminium cladding
- White uPVC windows with push-button security locks
- PVC gutters and down pipes
- Low energy exterior side light

INSULATION

- Thermaglas uPVC double glazing
- **NEW** improved thermal performance:
 - 80mm insulation in floor
 - 100mm insulation in roof
 - 60mm insulation in walls
 - Lagged underfloor pipes

INTERIOR

- 'Farmhouse' soft furnishing scheme
- Gas combi-boiler central heating and hot water system with radiator thermostats
- Luxury carpet with underlay throughout lounge and bedrooms
- **NEW** 'Provenza' grey toned vinyl flooring in kitchen/dining/ bathrooms
- 'Truffle Brown' woodgrain
- Low energy LED lighting throughout
- USB sockets
- Double electric sockets throughout
- **NEW** 'White Ash' wood interior doors

LOUNGE

- Full height front aspect fixed window
- Décor feature wall in 'Espresso'
- Spacious fixed L-shape 'Aston' sofa with cushions shaped for comfort and fold out occasional bed
- 'Tobacco Halifax' oak coffee table with 'Stone Grey' legs
- 'Tobacco Halifax' oak TV unit and storage with 'Truffle Brown' feature panel and overhead decorative shelf
- 'Pewter' curtain poles with lined curtains
- Nature Wall room divider in 'Tobacco Halifax' oak

KITCHEN / DINING

- Shaker style kitchen doors in 'Stone Grey' with 'Aerial' knob handles. Feature shelving in 'Tobacco Halifax' oak
- 30mm 'Tobacco Halifax' oak worktops with matching splashback
- 'Domapp' glass fronted oven and grill with electronic ignition
- Four-burner gas hob with electronic ignition
- Externally vented cooker hood
- 'Pewter' brushed steel tap, white resin sink bowl and drainer
- Integrated microwave oven (800w)
- Integrated fridge and freezer
- 'Tobacco Halifax' oak dining table with 'Truffle Brown' legs.
- Fixed bench seating and two freestanding chairs with cushion pads and 'Truffle Brown' legs

BATHROOM(S)

- Shower cubicle with thermostatic shower in main bathroom
- Dual flush WC
- LED vanity spotlights
- Extractor fan in main bathroom

BEDROOMS

- Double bed in main bedroom with 'Tobacco Halifax' oak bed surround and padded headboard in 'Andes Ecru'
- Deep and luxurious Aurora Duvalay™ mattress to all beds with Crib 5 rated fabric, and featuring 'S-Line' pocket springs and a high-density foam layer for increased and lasting comfort
- Bedside cabinets in 'Stone Grey' with 'Tobacco Halifax' oak table top
- Decorative feature wall in 'Espresso'
- Large double shaker style wardrobe in 'Stone Grey' with 'Aerial' knobs and feature shelving in 'Tobacco Halifax' oak (main bedroom)
- Twin beds with 'Tobacco Halifax' oak bed surround and padded fabric headboards in 'Montage Cardamom' overhead locker to the ceiling in 'Stone Grey' with feature shelving in 'Tobacco Halifax' oak (twin room)
- Large wardrobe in 'Stone Grey' and vanity area with mirror in 'Tobacco Halifax' oak (twin room)
- Roman blinds (3 bedrooms) or 'Pewter' curtain poles with blackout lined curtains (36' x 12' and 38' x 12') (twin room)
- USB points in all bedrooms

OPTIONS

- Front Aspect Sliding door
- 'Environmental Green' exterior with 'Anthracite' window frames
- 'Sandy Beige' exterior with 'Anthracite' window frames
- Bluetooth® audio connection to lounge ceiling speakers
- Integrated slim line dish washer
- Voiles to lounge and bedrooms
- Assisted lift up master bed with storage below
- Gazunda bed in twin bedrooms for extra space (one bed stores under the other when not required)
- Shaving socket in main bathroom
- Coffee table with upholstered stools

FLOOR PLANS

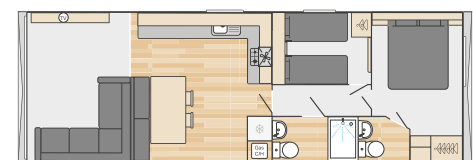

36' x 12' - 2 Bedroom

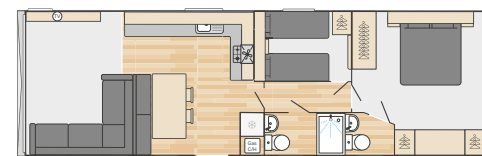

38' x 12' - 2 Bedroom

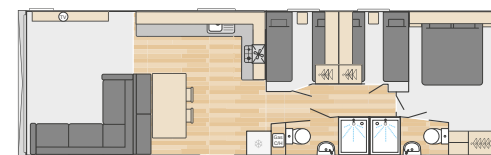

40' x 12' ES - 3 Bedroom

*The model fitted may differ from that shown in images, please check with supplying dealer or park.



Ardennes

The Ardennes has undergone a makeover, but we've kept all the features you know and love. Designed with families in mind, the Ardennes is sure to impress with its spacious living area and well-designed interior.



Features at a glance

Along with all the Swift key features on page 8, Ardennes comes with many desirable extras including:

Model size	Bedrooms	Main bed	Twin beds	Rear twin beds	Sofa Bed
28' x 12'	2	1.91m x 1.53m (6'3" x 5'0")	1.83m x 0.61m (6'0" x 2'0")	N/A	1.80m x 1.12m (5'11 x 3'8")
32' x 12'	2	1.91m x 1.53m (6'3" x 5'0")	1.83m x 0.69m (6'0" x 2'3")	N/A	1.80m x 1.12m (5'11 x 3'8")
36' x 12'	2	1.91m x 1.53m (6'3" x 5'0")	1.83m x 0.69m (6'0" x 2'3")	N/A	1.80m x 1.12m (5'11 x 3'8")
36' x 12'	3	1.91m x 1.53m (6'3" x 5'0")	1.83m x 0.69m (6'0" x 2'3")	1.83m x 0.69m (6'0" x 2'3")	1.80m x 1.12m (5'11 x 3'8")
38' x 12'	2	1.91m x 1.53m (6'3" x 5'0")	1.83m x 0.69m (6'0" x 2'3")	N/A	1.80m x 1.12m (5'11 x 3'8")
39' x 12' ES	3	1.91m x 1.53m (6'3" x 5'0")	1.83m x 0.69m (6'0" x 2'3")	1.83m x 0.69m (6'0" x 2'3")	1.80m x 1.12m (5'11 x 3'8")



Full window



Sofa bed



Spacious L-Shaped sofa



Freestanding dining table and chairs



Vanity area with mirror in main bathroom



USB sockets





Ardennes full features

EXTERIOR

- Fusion galvanised chassis with finish warrantied for ten years
- **NEW** thicker bonded sandwich exterior wall construction for strength and improved insulation
- Coated steel pantile roof
- Distinctive pre-coated 'folded' steel bargeboards with LED lighting to front aspect
- Woodgrain textured 'Sandy Beige' aluminium cladding
- White uPVC windows with push-button security locks
- PVC gutters and down pipes
- Low energy exterior side light

INSULATION

- Thermaglas uPVC double glazing
- **NEW** improved thermal performance:
 - 80mm insulation in floor
 - 100mm insulation in roof
 - 60mm insulation in walls
 - Lagged underfloor pipes

INTERIOR

- 7ft (2.13m) high ceilings at side walls
- Gas combi-boiler central heating and hot water system with radiator thermostats
- **NEW** 'Scandinavian' soft furnishings
- Luxury carpet with underlay throughout lounge and bedrooms
- 'Herringbone' effect vinyl flooring in kitchen/dining/main bathroom and ensuite
- Low energy LED lighting throughout
- USB sockets
- Good provision of double electric sockets throughout
- Hallway door (except 28' x 12' model)

LOUNGE

- Wide full height aspect windows
- Spacious fixed L-shape sofa with 'Dust Grey' base and cushions shaped for comfort and fold out occasional bed
- 'Dust Grey' TV unit with storage, 'Nebraska' feature panel with shelving
- TV point with Co-Ax and 240V socket for wall or stand mounted TV's

- Scenic side window next to TV surround (38' models only)
- Pewter curtain poles with lined curtains
- Coffee table in 'Nebraska' oak with 'Dust Grey' legs
- Foot stool in 28' and 32' models

KITCHEN / DINING

- Modern kitchen units with soft close doors and drawers in 'Dust Grey' with upper doors in 'Light Grey' with black Crofton handles.
- 'Nebraska' oak effect 30mm laminate worktops
- Black cast resin sink bowl and drainer with matching black tap
- **NEW** 'Domapp' glass fronted oven, grill and electronic ignition
- Four-burner gas hob with electronic ignition and large black glass splashback
- White externally vented extractor fan
- Integrated microwave oven (800w)*
- Integrated fridge and freezer
- Freestanding dining table and chairs

BATHROOM(S)

- Shower cubicle with thermostatic shower in main bathroom
- Stylish 'circles' feature walls
- LED vanity spotlights
- Dual flush WC
- Towel radiator in main bathroom with gas central heating option
- Radiator in ensuite
- Extractor fan in all shower rooms

BEDROOMS

- Deep and luxurious Aurora Duvalay™ mattress to all beds with Crib 5 rated fabric, and featuring 'S-Line' pocket springs and a high-density foam layer for increased and lasting comfort
- Fabric headboard(s)
- Stylish 'circles' feature walls at headboard
- Bedside tables in 'Nebraska' and 'Dust Grey'
- Large double wardrobe and vanity area with mirror (main bedroom). Large wardrobe and overhead ceiling lockers (twin bedroom)
- TV sockets & Co-Ax to all bedrooms plus booster
- Additional USB sockets to twin rooms
- 'Pewter' curtain poles with lined curtains

OPTIONS

- Front aspect sliding door
- 'Environmental Green' exterior with 'Anthracite' window frames
- 'Sandy Beige' exterior with 'Anthracite' window frames
- Bluetooth® audio connection to lounge ceiling speakers
- Assisted lift up master bed with storage below
- Gazunda bed in twin bedrooms for extra space (one bed stores under the other when not required)
- Integrated slim line dishwasher
- Upgraded coffee table with upholstered stools
- Shaving socket in bathroom
- Voiles to the lounge and bedrooms

FLOOR PLANS

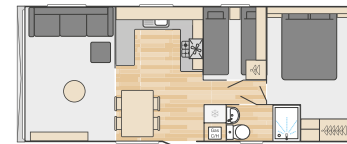

28' x 12' - 2 Bedroom

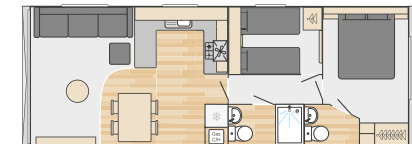

32' x 12' - 2 Bedroom

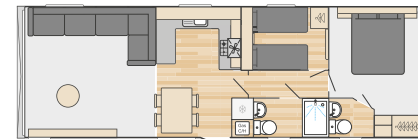

36' x 12' - 2 Bedroom

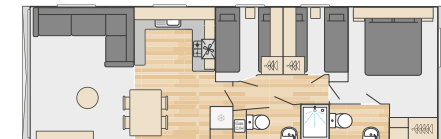

36' x 12' - 3 Bedroom

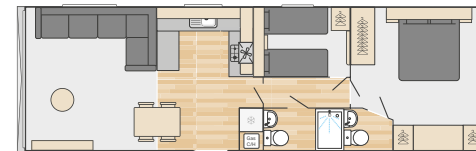

38' x 12' - 2 Bedroom

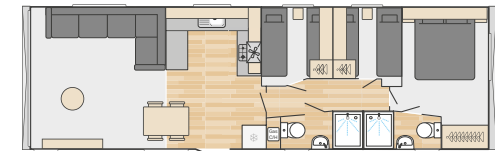

39' x 12' ES - 3 Bedroom

*The model fitted may differ from that shown in images, please check with supplying dealer or park.



Provence

The Provence Holiday Home presents a calming, country escape which is both easy on the budget and the eye. With 'Acanthium' soft furnishings, stylish flooring and décor and not forgetting an abundance of space throughout, this retreat blends style with practicality and is sure to be your perfect home away from home.

Features at a glance

Along with all the Swift key features on page 8, Provence also comes with many desirable extras including:

Model size	Bedrooms	Main bed	Twin beds	Rear twin beds	Sofa bed
35' x 12'	2	1.91m x 1.37m (6'3" x 4'6")	1.83m x 0.86m (6'0" x 2'3")	N/A	1.80m x 1.12m (5'11" x 3'8")
			1.76m x 0.69m (5'9" x 2'3")		
37' x 12'	3	1.91m x 1.37m (6'3" x 4'6")	1.83m x 0.69 (6'0" x 2'3")	1.83m x 0.61m (6'0" x 2'0")	1.80m x 1.12m (5'11" x 3'8")
			1.76m x 0.69m (5'9" x 2'3")		



Bay window



Sofa bed



Gazunder bed



USB sockets



4 Burner hob



Electric fire





Provence full features

EXTERIOR

- Fusion galvanised chassis with finish warranted for ten years
- Bonded sandwich exterior wall construction for greater strength
- Coated steel pantile roof
- Distinctive pre-coated 'folded' steel bargeboards
- Woodgrain textured 'Sandy Beige' aluminium cladding
- UPVC double glazed windows with push-button security locks
- PVC gutters and down pipes
- Low energy exterior side light
- Front bay window for wider panoramic views

INSULATION

- Thermaglas uPVC double glazed windows and doors
- Excellent thermal performance:
 - 60mm insulation in floor
 - 90mm insulation in roof
 - 30mm insulation in walls
 - Lagged underfloor pipes

INTERIOR

- 'Country Cottage' interior scheme with 'Acanthium' soft furnishings
- Gas combi-boiler central heating and hot water system with radiator thermostats
- Luxury carpet with underlay throughout lounge and bedrooms
- 'Tournai' stone effect vinyl flooring in kitchen/ dining/ bathrooms
- Modern 'Nebraska Oak' woodgrain
- Low energy LED lighting throughout
- USB sockets

LOUNGE

- Front bay window giving panoramic views with comfortable seating
- Freestanding 3 and 2 seater sofas (3 seater with sofa bed)
- Coffee table with upholstered footstools
- Lined curtains on poles with voiles
- Contemporary 2kW electric Optiflame® stove feature fire with mirror over fireplace
- High level TV position above the fire place and lower position on a fixed TV unit
- Framed wall picture and Mirror (above the fire)

KITCHEN / DINING

- Kitchen with country classic feel, featuring shaker style cupboards in 'Matt Dakar' with brass knobs and cup handles
- 'Nebraska Oak' 40mm laminate worktops with matching large splashbacks
- 'Thetford Cocina' glass fronted oven and grill with electronic ignition
- Four-burner gas hob with electronic ignition
- Full height metal splashback
- Externally vented cooker hood
- Integrated microwave oven (800w)*
- Integrated fridge/freezer
- Under sink waste bin
- White cast resin sink bowl and drainer with brass tap
- Freestanding dining table and chairs
- Welcome door mat

BATHROOM(S)

- Shower cubicle with thermostatic shower in main bathroom
- Dual flush WC
- LED vanity spotlights
- 'Dust Grey' splashbacks
- Extractor fan in main bathroom
- Shaver socket in main bathroom
- Mirrored vanity cabinet

BEDROOMS

- Deep and luxurious Aurora Duvalay™ mattress to all beds with Crib 5 rated fabric, and featuring 'S-Line' pocket springs and a high-density foam layer for increased and lasting comfort
- Upholstered 'Nebraska Oak' headboard(s)
- Bedside shelf units and overhead storage
- Vanity area with mirror and socket
- TV sockets & Co-Ax to all bedrooms plus booster
- USB sockets
- Double bed in main bedroom with lift up storage
- Gazunda bed in one twin bedroom for extra space (one bed stores under the other when not required)

OPTIONS

- 'Environmental Green' exterior with 'Anthracite' window frames
- 'Sandy Beige' exterior with 'Anthracite' window frames
- Kitchen Velux
- Bluetooth® audio connection to lounge ceiling speakers

FLOOR PLANS



35' x 12' - 2 Bedroom

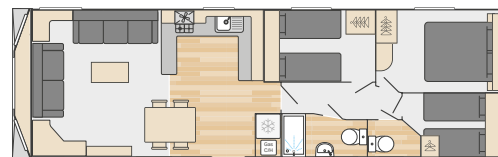

37' x 12' - 3 Bedroom

*The model fitted may differ from that shown in images, please check with supplying dealer or park.



Loire

Bright, fun and functional, the beloved Loire has received a makeover, offering superb value with a fresh new look. Available in variety of sizes and layouts, Loire continues to provide family-friendly accommodation, hardwearing materials and quality equipment.

Model size	Bedrooms	Main bed	Twin beds	Rear twin beds	Sofa bed
28' x 12'	2	1.91m x 1.53m (6'3" x 5'0")	1.83m x 0.61m (6'0" x 2'0")	N/A	1.80m x 1.12m (5'11" x 3'8")
32' x 12'	2	1.91m x 1.53m (6'3" x 5'0")	1.83m x 0.69m (6'0" x 2'3")	N/A	1.80m x 1.12m (5'11" x 3'8")
36' x 12'	2	1.91m x 1.53m (6'3" x 5'0")	1.83m x 0.69m (6'0" x 2'3")	N/A	1.80m x 1.12m (5'11" x 3'8")
36' x 12'	3	1.91m x 1.53m (6'3" x 5'0")	1.83m x 0.69m (6'0" x 2'3")	1.83m x 0.69m (6'0" x 2'3")	1.80m x 1.12m (5'11" x 3'8")
38' x 12'	2	1.91m x 1.53m (6'3" x 5'0")	1.83m x 0.69m (6'0" x 2'3")	N/A	1.80m x 1.12m (5'11" x 3'8")
38' x 12'	3	1.91m x 1.53m (6'3" x 5'0")	1.83m x 0.69m (6'0" x 2'3")	1.83m x 0.69m (6'0" x 2'3")	1.80m x 1.12m (5'11" x 3'8")



Features at a glance

Along with all the Swift key features on page 8, Loire comes with many desirable extras including:



Bay window



Sofa bed



Spacious L-Shaped sofa



USB sockets



4 Burner hob



Wardrobe





Loire full features

EXTERIOR

- Fusion galvanised chassis with finish warranted for ten years
- Bonded sandwich exterior wall construction for greater strength
- Coated steel pantile roof
- Distinctive pre-coated 'folded' steel bargeboards
- Woodgrain textured 'Sandy Beige' aluminium cladding
- White uPVC windows with push-button security locks
- PVC gutters and down pipes
- Low energy exterior side light

INSULATION

- Thermaglas uPVC double glazing
- **NEW** improved thermal performance:
 - 80mm insulation in floor
 - 100mm insulation in roof
 - 60mm insulation in walls
 - Lagged underfloor pipes

INTERIOR

- **NEW** 'Coastal' soft furnishings
- Gas combi-boiler central heating and hot water system with radiator thermostats
- Luxury carpet with underlay throughout lounge and bedrooms
- 'Tournai' vinyl flooring in kitchen/dining/ bathroom(s)
- 'Navarra Ash' woodgrain with 'White Ash' wood interior doors
- Low energy LED lighting throughout
- USB sockets
- Electric sockets throughout

LOUNGE

- **NEW** Front bay panoramic window
- Spacious fixed L-shape sofa with 'Dust Grey' base and cushions shaped for comfort and fold out occasional bed
- 'Light Grey' TV unit with storage, 'Navarra Ash' feature panel with shelving
- TV point with Co-Ax and 240V socket for wall or stand mounted TV's
- Scenic side window next to TV surround (38' models only)
- Chrome curtain poles with lined curtains and tie backs
- Oval coffee table in 'Light Grey'

KITCHEN / DINING

- Spacious 'L' Shaped Kitchen with Shaker style kitchen units with chrome 'Aerial' knobs and soft close doors and drawers in 'Light Grey' with matching cornice
- 'Navarra Ash' 30mm laminate worktops
- Stainless steel sink bowl and drainer with matching tap
- **NEW** 'Domapp' glass fronted oven, grill and electronic ignition
- Four-burner gas hob with electronic ignition and large black glass splashback
- Externally vented hob extractor fan*
- Integrated microwave oven (800w)
- Integrated 70/30 fridge and freezer
- Fixed dining table with 'Navarra Ash' top. **NEW** fixed L shaped seating with 'Dusk Grey' upholstered poufs

BATHROOM(S)

- Shower cubicle with thermostatic shower in main bathroom
- Dual flush WC
- LED vanity spotlights
- Extractor fan in main bathroom

BEDROOMS

- Deep and luxurious Aurora Duvalay™ mattress to all beds with Crib 5 rated fabric, and featuring 'S-Line' pocket springs and a high-density foam layer for increased and lasting comfort
- King sized bed in main bedroom with headboard in 'Hugo Indigo'. Overhead storage in 'Navarra Ash'
- Bedside tables in 'Navarra Ash' and 'Light Grey'
- Large double wardrobe in 'Navarra Ash' with chrome 'Aerial' knobs and vanity area with mirror (main bedroom) Large wardrobe in 'Light Grey', overhead ceiling lockers and vanity area with mirror (twin bedroom)
- Chrome curtain poles with blackout lined curtains (main bedroom), roman blinds (twin bedrooms 28' x 12' 2 bed, 36' x 12' 3 bed, 38' x 12' 3 bed)
- **NEW** USB points in all bedrooms

OPTIONS

- 'Environmental Green' exterior with 'Anthracite' window frames
- 'Sandy Beige' exterior with 'Anthracite' window frames
- Bluetooth® audio connection to lounge ceiling speakers
- Assisted lift up master bed with storage below
- Gazunda bed in twin bedrooms for extra space (one bed stores under the other when not required)
- Freestanding dining table with 'Navarra Ash' top. **NEW** fixed L shaped seating with 'Dusk Grey' upholstered poufs
- Voiles to the lounge and bedrooms
- Integrated slim line dishwasher
- Coffee table with upholstered stools
- Shaving socket in main bathroom

FLOOR PLANS

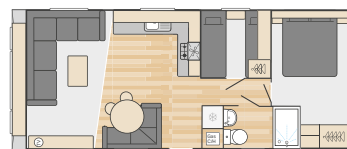

28' x 12' - 2 Bedroom

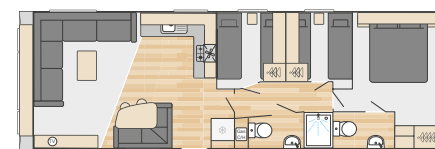

36' x 12' - 3 Bedroom

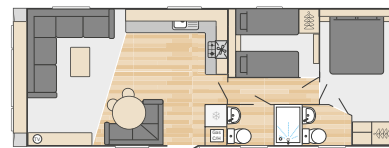

32' x 12' - 2 Bedroom

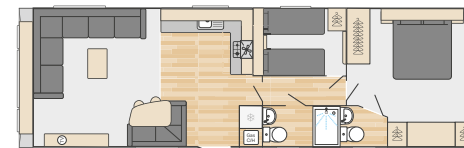

38' x 12' - 2 Bedroom



36' x 12' - 2 Bedroom



38' x 12' - 3 Bedroom

*The model fitted may differ from that shown in images, please check with supplying dealer or park.



Atlantique



Bright, fun and functional, the coastal-inspired Atlantique delivers superb value in a choice of 10ft and 12ft-wide, two and three-bedroom models. Retaining the family-friendly accommodation, hardwearing materials and quality equipment, Atlantique now boasts a nautical-inspired interior, alongside enhanced features.

Model size	Bedrooms	Main bed	Twin beds	Rear twin beds	Sofa bed
28' x 10'	2	1.91m x 1.37m (6'3" x 4'6")	1.83m x 0.61m (6'0" x 2'0") 1.76m x 0.61m (5'9" x 2'0")	N/A	1.80m x 1.12m (5'11" x 3'8")
28' x 12'	2	1.91m x 1.37m (6'3" x 4'6")	1.83m x 0.69m (6'0" x 2'3") 1.76m x 0.69m (5'9" x 2'3")	N/A	1.80m x 1.12m (5'11" x 3'8")
32' x 10'	2	1.91m x 1.37m (6'3" x 4'6")	1.83m x 0.69m (6'0" x 2'3") 1.76m x 0.69m (5'9" x 2'3")	N/A	1.80m x 1.12m (5'11" x 3'8")
32' x 12'	2	1.91m x 1.37m (6'3" x 4'6")	1.83m x 0.69m (6'0" x 2'3") 1.76m x 0.69m (5'9" x 2'3")	N/A	1.80m x 1.12m (5'11" x 3'8")
35' x 12'	2	1.91m x 1.37m (6'3" x 4'6")	1.83m x 0.69m (6'0" x 2'3") 1.76m x 0.69m (5'9" x 2'3")	N/A	1.80m x 1.12m (5'11" x 3'8")
35' x 12'	3	1.91m x 1.37m (6'3" x 4'6")	1.83m x 0.69m (6'0" x 2'3") 1.76m x 0.69m (5'9" x 2'3")	1.83m x 0.61m (6'0" x 2'0")	1.80m x 1.12m (5'11" x 3'8")
38' x 12'	3	1.91m x 1.37m (6'3" x 4'6")	1.83m x 0.69m (6'0" x 2'3") 1.76m x 0.69m (5'9" x 2'3")	1.83m x 0.61m (6'0" x 2'0")	1.80m x 1.12m (5'11" x 3'8")

Features at a glance

Along with all the Swift key features on page 8, Atlantique comes with many desirable extras including:



Bay window



Sofa bed



Gazunder bed



USB sockets



4 Burner hob



Wardrobe





Atlantique full features

EXTERIOR

- Fusion galvanised chassis with finish warranted for ten years
- Bonded sandwich exterior wall construction for greater strength
- Coated steel pantile roof
- Distinctive pre-coated 'folded' steel bargeboards
- Woodgrain textured 'Sandy Beige' aluminium cladding
- White uPVC windows with push-button security locks
- PVC gutters and down pipes
- Low energy exterior side light

INSULATION

- Floor, roof and bonded exterior walls are insulated to provide excellent thermal performance. All external pipework is lagged to help prevent freezing. See website for further details

INTERIOR

- Wesley soft furnishings
- Luxury carpet with underlay
- Gas combi-boiler central heating and hot water system with radiator thermostats
- Tournai Stone effect vinyl flooring in kitchen/dining/bathroom(s)
- Tisano Oak woodgrain (with Truffle Brown feature panels)
- Low energy LED lighting throughout
- USB sockets
- Good provision of double electric sockets throughout
- Hallway door (35' and 38' x 12' models)

LOUNGE

- Front bay window giving panoramic views and more comfortable front seating
- Fixed L-shape sofa with fold out occasional bed and loose back cushions
- Coffee table (except 10ft models)
- Lined curtains with tiebacks with curtain poles
- TV point with Co-Ax and 240V socket

KITCHEN / DINING

- Thetford glass fronted oven and grill with electronic ignition
- Four-burner gas hob with electronic ignition
- Externally vented stainless steel cooker hood

- Integrated microwave oven (800w)*
- Integrated fridge and freezer (12' models)
- Under counter fridge (10' models)
- Silver Chromix 30mm laminate worktops with matching upstands
- Stainless steel bar handles for kitchen cupboards
- Stainless steel sink/drainer
- Freestanding dining table with fixed style seating and two stools

BATHROOM(S)

- Shower cubicle with thermostatic shower in main bathroom
- Dual flush WC
- LED vanity spotlights
- Extractor fan in main bathroom

BEDROOMS

- Deeper and more luxurious Aurora Duvalay™ mattress to all beds with Crib 5 rated fabric, and featuring 'S-Line' pocket springs and a high-density foam layer for increased and lasting comfort
- Avola woodgrain headboards
- Gazunda bed in one twin bedroom for extra space (one bed stores under the other when not required)
- Bedside shelf units and overbed storage
- Contemporary handleless furniture design and feature panels in Truffle brown
- Vanity area with mirror and socket
- TV sockets & Co-Ax to all bedrooms plus booster (except 28' x 12' two bed)

OPTIONS

- Thermaglas uPVC double glazing
- 'Environmental Green' aluminium exterior with 'Anthracite' window frames
- Freestanding dining table and freestanding chairs in place of fixed dinette
- Electric fire
- Bluetooth® audio connection to lounge ceiling speakers
- Shaving socket in bathroom

FLOOR PLANS



28' x 10' - 2 Bedroom

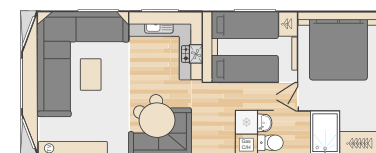

28' x 12' - 2 Bedroom

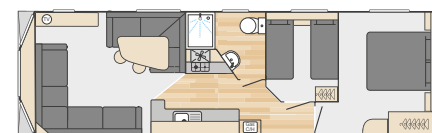

32' x 10' - 2 Bedroom

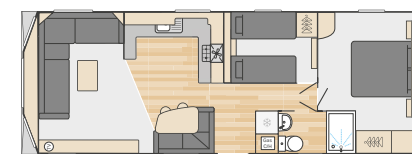

32' x 12' - 2 Bedroom

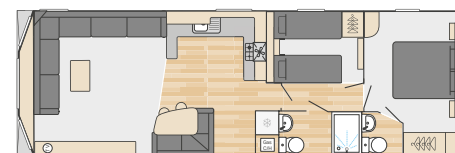

35' x 12' - 2 Bedroom

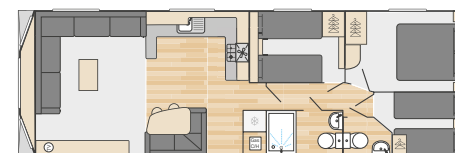

35' x 12' - 3 Bedroom

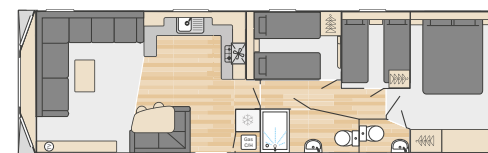

38' x 12' - 3 Bedroom

*The model fitted may differ from that shown in images, please check with supplying dealer or park.



Royan



Meet the Royan, a brand new affordable holiday home that delivers great value with looks to match. The Royan is designed with families in mind. Its spacious open-plan living area boasts a fresh 'Silas' soft furnishings scheme, whilst clever storage saving solutions are found throughout, ensuring every inch is utilised efficiently.

Features at a glance

Along with all the Swift key features on page 8, Royan also comes with many desirable extras including:

Model size	Bedrooms	Main bed	Twin beds	Rear twin beds
28' x 12'	2	1.91m x 1.37m (6'3" x 4'6")	1.83m x 0.69m (6'0" x 2'3")	
35' x 12'	2	1.91m x 1.37m (6'3" x 4'6")	1.83m x 0.69m (6'0" x 2'3")	
			1.76m x 0.69m (5'9" x 2'3")	
35' x 12'	3	1.91m x 1.37m (6'3" x 4'6")	1.83m x 0.69m (6'0" x 2'3")	1.83m x 0.61m (6'0" x 2'0")
			1.76m x 0.69m (5'9" x 2'3")	



Flat fronted window



Spacious L-Shaped sofa



Gazunder bed



USB sockets



4 Burner hob



Wardrobe





Royan full features

EXTERIOR

- Fusion galvanised chassis with finish warranted for ten years
- Bonded sandwich exterior wall construction for greater strength
- Coated steel pantile roof
- Distinctive pre-coated 'folded' steel bargeboards
- Woodgrain textured 'Sandy Beige' aluminium cladding
- White uPVC windows with push-button security locks
- PVC gutters and down pipes
- Low energy exterior side light

INSULATION

- Excellent thermal performance:
 - Air-filled standard glass windows and doors
 - 60mm insulation in floor
 - 90mm insulation in roof
 - 30mm insulation in walls
 - Lagged underfloor pipes

INTERIOR

- **NEW** 'Silas' soft furnishings
- Luxury carpet with underlay throughout the lounge and bedrooms
- Gas combi-boiler central heating and hot water system with radiator thermostats
- Hardwearing vinyl flooring in 'Tournai Stone' in kitchen, hallway and bathroom
- 'Tisano' woodgrain with 'Dust Grey' feature panels
- Low energy LED lighting throughout
- Electric sockets throughout

LOUNGE

- Large flat fronted window offering panoramic views
- Spacious fixed L-shape sofa with 'Dust Grey' base and cushions shaped for comfort
- Contemporary coffee table
- Stylish media unit with 'Dust Grey' feature panel, DVD position with drawer and TV point with Co-Ax and 240V socket
- Printed curtains with curtain poles

KITCHEN / DINING

- 'Domapp' glass fronted oven and grill with electronic ignition
- Four-burner gas hob with electronic ignition
- Externally vented stainless steel cooker hood
- Sleek handle-less kitchen units to the ceiling in 'Tisano' with stylish 'Porcelain' doors
- 'Silver Chromix' 30mm laminate worktops
- Space for freestanding fridge / freezer
- Space for microwave with overhead shelf
- Stainless steel sink/drainer
- Dining table with freestanding bench seating and seating cushions

BATHROOM(S)

- Shower cubicle with thermostatic shower in main bathroom
- Dual flush WC
- Vanity mirror and shelf in 'Tisano'

BEDROOMS

- **NEW** 'Cignus' 'Duvalay™' mattress to all beds providing excellent cushioning and comfort for a restful, peaceful night's sleep
- Stylish 'Tisano' woodgrain headboards
- Contemporary bedside units and overhead shelving in 'Tisano'
- Gazunda bed with 'Cirrus' 'Duvalay™' mattress in one twin bedroom for extra space (one bed stores under the other when not required)
- Vanity area with mirror and socket
- Spacious double wardrobe

OPTIONS

- 'Environmental Green' aluminium exterior with 'Anthracite' window frames
- 'Sandy Beige' exterior with 'Anthracite' window frames
- Freestanding fridge freezer
- Freestanding microwave
- Pull out sofa bed
- Wireless programmable room thermostat
- Bluetooth® audio connection to lounge ceiling speakers
- Coffee table with upholstered fabric stools
- Curtain voiles to lounge and bedrooms
- Lift up double bed in main bedroom
- Royan delux pack:
 - Integrated fridge freezer
 - Integrated microwave
 - Arms to sofa
 - Freestanding dining chairs
- TV point and booster in main bedroom with additional USB sockets throughout
- Shaver socket in main bathroom
- Bathroom extractor fan

FLOOR PLANS



28' x 12'
2 Bedroom

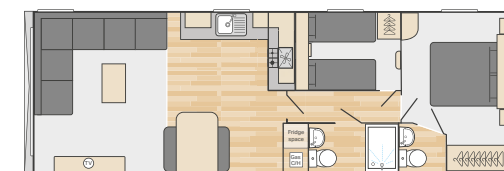

35' x 12' - 2 Bedroom

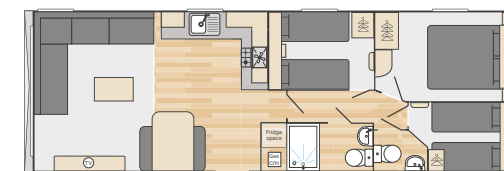

35' x 12' - 3 Bedroom

*The model fitted may differ from that shown in images, please check with supplying dealer or park.

Range at a glance

	Montreal	Vendee	Margaux	Bordeaux	Morlaix	Ardennes	Provence	Loire	Atlantique	Royan
Exterior										
Fusion chassis with galvanised finish warrantied for 10 years	•	•	•	•	•	•	•	•	•	•
Bonded 'sandwich' exterior wall construction	•	•	•	•	•	•	•	•	•	•
Coated steel pantile roof	•	•	•	•	•	•	•	•	•	•
Distinctive 'folded' steel bargeboards with lighting	•	•	•	•	•	•	No lighting	No lighting	No lighting	•
Woodgrain textured aluminium cladding	•	•	•	•	•	•	•	•	•	•
Front aspect sliding doors	•	•	Option	Option	Option	Option				
uPVC windows with push-button security locks	•	•	•	•	•	•	•	•	•	•
PVC gutters and down pipes	•	•	•	•	•	•	•	•	•	•
Low energy exterior light	•	•	•	•	•	•	•	•	•	•
Environmental exterior	Option	Option	Option	Option	Option	Option	Option	Option	Option	Option
Insulation										
'Thermaglas' uPVC double glazing	•	•	•	•	•	•	•	•	•	•
Insulation thickness in floor	25mm PIR	60mm	80mm	60mm	80mm	80mm	60mm	80mm	60mm	60mm
Insulation thickness in roof	100mm	90mm	100mm	90mm	100mm	100mm	90mm	100mm	90mm	90mm
Insulation thickness in walls	60mm	30mm	60mm	30mm	60mm	60mm	30mm	60mm	30mm	30mm
Lagged underfloor pipes	•	•	•	•	•	•	•	•	•	•
Interior										
Condensing gas combi-boiler central heating and hot water system (GCH)	•	•	•	•	•	•	•	•	Option	•
Luxury carpet with underlay throughout to bedroom and lounge	•	•	•	•	•	•	•	•	•	•
Hardwearing vinyl flooring in uncarpeted rooms	•	•	•	•	•	•	•	•	•	•
Low energy LED lighting throughout	•	•	•	•	•	•	•	•	•	•
Planked interior ceiling system	•	•								
USB sockets	•	•	•	•	•	•	•	•	•	•
Woodgrain	Tobacco Halifax Oak	Nebraska Oak	Tobacco Halifax Oak	Nebraska Oak	Tobacco Halifax Oak	Nebraska Oak	Nebraska Oak	Navara Ash	Tisano Oak	Tisano Oak
Lounge										
Freestanding sofas with scatter cushions	•	•	•	•			•			
Fixed sofas with scatter cushions					•	•		•	•	•
Pull-out sofa bed mechanism	Option	Option	•	•	•	•	•	•	•	Option
Footstool(s)	Option	•	•	•	Option	28' and 32' model	•	Option		Option
Coffee table	•	•	•	•	•	•	•	•	Except 10ft models	Option
Contemporary electric fire		•	Option	Option			•		Option	
Provision for Sky+ connection		•								
Bluetooth audio connection to lounge ceiling speaker	Option	Option	Option	Option	Option	Option	Option	Option	Option	Option
Framed wall pictures	Option	•	•	•			•			

	Montreal	Vendee	Margaux	Bordeaux	Morlaix	Ardennes	Provence	Loire	Atlantique	Royan
Kitchen/dining										
Glass fronted oven and grill with electronic ignition	•	•	•	•	•	•	•	•	•	•
Cooker hood with extractor vented to outside	•	•	•	•	•	•	•	•	•	•
4-burner gas hob with electronic ignition	•	Five	•	•	•	•	•	•	•	•
Integrated fridge and freezer	•	•	•	•	•	•	•	•	12' models	Option (freestanding or integrated)
Under counter fridge									10' models	
Microwave oven	•	•	•	•	•	•	•	•	•	Option
12 place dishwasher / 10 plate slimline dishwasher (if washing machine not fitted)	Option	Option	Option	Option	Option	Option		Option		
Built-in washing machine with furniture door (if dishwasher not fitted)	Option (both)	Option								
Sink / drainer	•	•	•	•	•	•	•	•	•	•
Laminate worktops with matching upstands	•	•	•	•	•	•	•	•	•	•
Soft-closing drawers	•	•	•	•	•	•	•	•	•	•
Fixed dinette					•				•	•
Freestanding dining suite	•	•	•	•		•	•	Option		•
Bathroom(s)										
Shower cubicle with thermostatic shower in main bathroom	En-suite	•	•	•	•	•	•	•	•	•
Dual flush WC	•	•	•	•	•	•	•	•	•	•
Extractor fan in main bathroom	•	•	•	•	•	•	•	•	•	Option
Towel radiator in shower rooms	•	•	•	•	•	•	•	•	•	
Radiator in en-suite	•	•	•	•	•	•	•	•	•	
Towel radiator with shower(s)	•	•	•	•	•	•	•	•	•	
LED vanity lighting	•	•	•	•	•	•	•	•	•	•
Shower cubicle topper	Ensuite	•	•	•	•	•	•	•	•	
Shaver socket in bathroom	Option	Option	Option	Option	Option	Option	•	Option	Option	Option
Bedrooms										
Lift-up bed allowing easy access to storage area	•	•	•	•	Option	Option	•	Option		Option
One bed stores under the other for extra space in one twin bedroom			Option	Option	Option	Option		Option	•	Option
Duvalay™ Crib 5 mattress	•	•	•	•	•	•	•	•	•	•
Padded headboard(s)		•	•	•	•	•	•	•		
Reading lights	•	•	•	•						
TV sockets & Co-Ax to all bedrooms plus booster	•	•	•	•	•	•	•	•	Except 29ft models	Option for Main bedroom
Safety										
Mains linked Smoke and Heat alarms	•	•	•	•	•	•	•	•	•	•
5-year carbon monoxide detectors	•	•	•	•	•	•	•	•	•	•
Fire extinguisher	•	•	•	•	•	•	•	•	•	•
Fire blanket	•	•	•	•	•	•	•	•	•	•

Exterior finishes

Swift holiday homes are designed for long-lasting great looks. The exterior is woodgrain textured aluminium cladding.

SANDY BEIGE



ENVIRONMENTAL GREEN



WOODGRAIN TEXTURED ALUMINIUM	STANDARD SANDY BEIGE	OPTIONAL ENVIRONMENTAL GREEN
Models		
Montreal	✓	✓
Vendee	✓	✓
Margaux	✓	✓
Bordeaux	✓	✓
Morlaix	✓	✓
Ardennes	✓	✓
Provence	✓	✓
Loire	✓	✓
Atlantique	✓	✓
Royan	✓	✓

Holiday Home Decking & Skirting Systems

Designed to enhance the outdoor lifestyle of today's modern Holiday Homes & Static Caravans, leading UK manufacturer FENSYS supply the very highest quality & specification, low maintenance UPVC Decking and Skirting systems.

Contact us today and here's what you will get:

- ✓ **Expertise...**
Expert advice and products from a blue chip company doubled with professional care and attention provided by our extensive network of qualified sales and installation service providers.
- ✓ **Experience...**
A British company with over 30 years experience in manufacturing. Our team of technical advisers, market specialists and customer service staff are on hand to help and advise.
- ✓ **Quality...**
Superior market leading product, Fensys manufacture the very highest specification low maintenance decking and balustrade products.
- ✓ **Engineered to last...**
Professionally fitted and exceptionally strong Fensys even offer a galvanised metal sub-frame up grade to further extend the products life.
- ✓ **Designed to please...**
Slip resistant and bare foot friendly our natural tone deck board colour options are designed to give years of untroubled enjoyment.
- ✓ **Made to match...**
Choose from 8 balustrade colour options to match or contrast your holiday home; white, cream, beige as well as 4 window matching wood grains are all available.
- ✓ **Your ideas welcomed...**
Fensys offer standard as well as bespoke veranda designs, let our team of professional advisers help turn your dream into a reality.
- ✓ **Customised by you...**
Accessorise with our hand rail style options 'Madison or Georgian', bowed spindles, glass panels, post lights, gates, ramps, solid and ranch style skirting.
- ✓ **Local coverage...**
We have the largest network of professional sales and installation service providers. Covering the whole of the U.K. and beyond, let us put you in touch with our local agent today.



Dimensions

- L1** Overall length including detachable towbar
- L2** Overall length excluding detachable towbar
- L3** Body length (including bay where applicable)
- L4** Body length at floor level
- W1** Overall width including gutters and down pipes
- W2** Width at floor level
- H1** Overall height

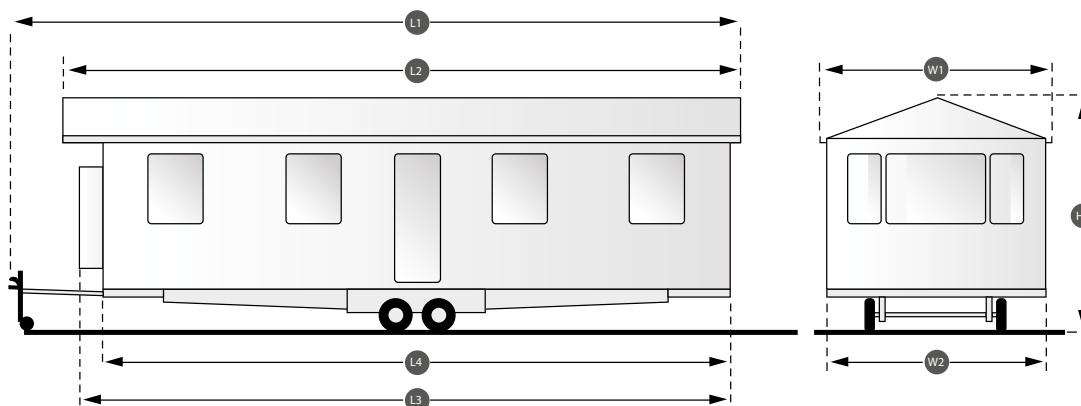

Model	L1	L2	L3	L4	W1	W2	H1
Royan 28x12-2B	9.63m (31' 7")	8.75m (28' 9")	8.63m (28' 4")	8.63m (28' 4")	3.96m (13' 0")	3.70m (12' 2")	3.45m (11' 4")
Royan 35x12-2B	11.93m (39' 2")	11.10m (36' 5")	10.93m (35' 10")	10.93m (35' 10")	3.96m (13' 0")	3.70m (12' 2")	3.45m (11' 4")
Royan 35x12-3B	11.93m (39' 2")	11.10m (36' 5")	10.93m (35' 10")	10.93m (35' 10")	3.96m (13' 0")	3.70m (12' 2")	3.45m (11' 4")
Atlantique 28x10-2B	9.63m (31' 7")	9.10m (29' 10")	8.87m (29' 1")	8.63m (28' 4")	3.35m (11' 0")	3.05m (10' 0")	3.29m (10' 10")
Atlantique 28x12-2B	9.63m (31' 7")	9.10m (29' 10")	8.87m (29' 1")	8.63m (28' 4")	3.96m (13' 0")	3.70m (12' 2")	3.41m (11' 2")
Atlantique 32x10-2B	10.77m (35' 4")	10.25m (33' 7")	10.05m (33' 0")	9.77m (32' 1")	3.35m (11' 0")	3.05m (10' 0")	3.29m (10' 10")
Atlantique 32x12-2B	10.77m (35' 4")	10.25m (33' 7")	10.05m (33' 0")	9.77m (32' 1")	3.96m (13' 0")	3.70m (12' 2")	3.41m (11' 2")
Atlantique 35x12-2B	11.94m (39' 2")	11.40m (37' 5")	11.21m (36' 9")	10.94m (35' 11")	3.96m (13' 0")	3.70m (12' 2")	3.41m (11' 2")
Atlantique 35x12-3B	11.94m (39' 2")	11.40m (37' 5")	11.21m (36' 9")	10.94m (35' 11")	3.96m (13' 0")	3.70m (12' 2")	3.41m (11' 2")
Atlantique 38x12-3B	12.73m (41' 9")	12.20m (40' 0")	12.00m (39' 5")	11.73m (38' 6")	3.96m (13' 0")	3.70m (12' 2")	3.41m (11' 2")
Loire 28x12-2B	9.78m (32' 1")	9.25m (30' 4")	9.08m (29' 9")	8.78m (28' 10")	4.02m (13' 2")	3.76m (12' 4")	3.60m (11' 10")
Loire 32x12-2B	10.85m (35' 7")	10.33m (33' 10")	10.15m (33' 4")	9.85m (32' 4")	4.02m (13' 2")	3.76m (12' 4")	3.60m (11' 10")
Loire 36x12-2B	11.99m (39' 4")	11.46m (37' 7")	11.29m (37' 0")	10.99m (36' 1")	4.02m (13' 2")	3.76m (12' 4")	3.60m (11' 10")
Loire 36x12-3B	11.99m (39' 4")	11.46m (37' 7")	11.29m (37' 0")	10.99m (36' 1")	4.02m (13' 2")	3.76m (12' 4")	3.60m (11' 10")
Loire 38x12-2B	12.79m (42' 0")	12.26m (40' 3")	12.09m (39' 8")	11.79m (38' 8")	4.02m (13' 2")	3.76m (12' 4")	3.60m (11' 10")
Loire 38x12-3B	12.74m (41' 10")	12.26m (40' 3")	12.04m (39' 6")	11.74m (38' 6")	4.02m (13' 2")	3.76m (12' 4")	3.60m (11' 10")
Provence 35x12-2B	11.94m (39' 2")	11.40m (37' 5")	11.21m (36' 9")	10.94m (35' 11")	3.96m (13' 0")	3.70m (12' 2")	3.39m (11' 10")
Provence 37x12-3B	12.44m (40' 10")	11.91m (39' 1")	11.71m (38' 5")	11.44m (37' 6")	3.96m (13' 0")	3.70m (12' 2")	3.39m (11' 10")
Ardennes 28x12-2B	9.78m (32' 1")	9.20m (30' 2")	8.78m (28' 10")	8.78m (28' 10")	4.02m (13' 2")	3.76m (12' 4")	3.60m (11' 10")
Ardennes 32x12-2B	10.85m (35' 7")	10.28m (33' 9")	9.85m (32' 4")	9.85m (32' 4")	4.02m (13' 2")	3.76m (12' 4")	3.60m (11' 10")
Ardennes 36x12-2B	12.04m (39' 6")	11.47m (37' 7")	11.04m (36' 3")	11.04m (36' 3")	4.02m (13' 2")	3.76m (12' 4")	3.60m (11' 10")
Ardennes 36x12-3B	12.01m (39' 5")	11.11m (36' 6")	11.01m (36' 1")	11.01m (36' 1")	4.02m (13' 2")	3.76m (12' 4")	3.60m (11' 10")
Ardennes 38x12-2B	12.81m (42' 0")	12.21m (40' 1")	11.81m (38' 9")	11.81m (38' 9")	4.02m (13' 2")	3.76m (12' 4")	3.60m (11' 10")
Ardennes 39x12-3B ES	12.81m (42' 0")	12.21m (40' 1")	11.81m (38' 9")	11.81m (38' 9")	4.02m (13' 2")	3.76m (12' 4")	3.60m (11' 10")
Morlaix 36x12-2B	11.89m (39' 0")	11.31m (37' 1")	10.89m (35' 9")	10.89m (35' 9")	4.02m (13' 2")	3.76m (12' 4")	3.60m (11' 10")
Morlaix 38x12-2B	12.79m (42' 0")	12.21m (40' 1")	11.79m (38' 8")	11.79m (38' 8")	4.02m (13' 2")	3.76m (12' 4")	3.60m (11' 10")
Morlaix 40x12-3B	13.19m (43' 3")	12.76m (41' 10")	12.19m (40' 0")	12.19m (40' 0")	4.02m (13' 2")	3.76m (12' 4")	3.60m (11' 10")
Bordeaux 33x12-2B	11.09m (36' 5")	10.50m (34' 5")	10.09m (33' 1")	10.09m (33' 1")	3.96m (13' 0")	3.70m (12' 2")	3.60m (11' 10")
Bordeaux 35x12-2B	11.93m (39' 2")	11.35m (37' 3")	10.93m (35' 10")	10.93m (35' 10")	3.96m (13' 0")	3.70m (12' 2")	3.60m (11' 10")
Bordeaux 38x12-2B / Bordeaux 38x12-2B ES	12.75m (41' 10")	12.15m (39' 11")	11.75m (38' 7")	11.75m (38' 7")	3.96m (13' 0")	3.70m (12' 2")	3.60m (11' 10")
Bordeaux 38x12-3B	12.75m (41' 10")	12.15m (39' 11")	11.75m (38' 7")	11.75m (38' 7")	3.96m (13' 0")	3.70m (12' 2")	3.60m (11' 10")
Margaux 33x12-2B	11.14m (36' 7")	10.56m (38' 8")	10.14m (33' 3")	10.14m (33' 3")	4.02m (13' 2")	3.76m (12' 4")	3.60m (11' 10")
Margaux 35x12-2B	11.99m (39' 4")	11.41m (37' 5")	10.99m (36' 1")	10.99m (36' 1")	4.02m (13' 2")	3.76m (12' 4")	3.60m (11' 10")
Margaux 38x12-2B	12.79m (42' 0")	12.21m (40' 1")	11.79m (38' 8")	11.79m (38' 8")	4.02m (13' 2")	3.76m (12' 4")	3.60m (11' 10")
Margaux 38x12-2B ES	12.79m (42' 0")	12.21m (40' 1")	11.79m (38' 8")	11.79m (38' 8")	4.02m (13' 2")	3.76m (12' 4")	3.60m (11' 10")
Margaux 38x12-3B	12.79m (42' 0")	12.21m (40' 1")	11.79m (38' 8")	11.79m (38' 8")	4.02m (13' 2")	3.76m (12' 4")	3.60m (11' 10")
Vendee 40x12-2B	13.39m (43' 11")	12.81m (42' 0")	12.39m (40' 8")	12.39m (40' 8")	3.96m (13' 0")	3.70m (12' 2")	3.54m (11' 7")
Montreal 40x20-2B	13.23m (43' 5") Est	12.65m (41' 6") Est	12.23m (40' 1") Est	12.23m (40' 1") Est	6.25m (20' 6") Est	6.02m (19' 9") Est	4.07m (13' 4") Est
Montreal 41x20-3B	13.53m (44' 5") Est	12.95m (42' 6") Est	12.53m (41' 1") Est	12.53m (41' 1") Est	6.25m (20' 6") Est	6.02m (19' 9") Est	4.07m (13' 4") Est

Est = Estimate



Only Swift approved partners sell approved Swift holiday homes and lodges

Swift wants to make sure your buying experience is the best it can be. When you buy from a Swift Approved Partner, you can rest assured that your holiday home is fully supported by Swift Group and the supplying distributor.

The benefits of buying from a Swift Approved Partner include:

- Swift Group Approved Warranty
- Dealer access to Swift Connect aftersales support
- Approved spare parts
- Approved engineers
- Access to Swift Approved technical engineers
- Product on display at distributors
- Financial services to help with your purchase*

Find your nearest Swift Approved Partner from our list on the back of the brochure or the Swift Holiday Homes website, swiftholidayhomes.co.uk, and look out for the Swift Approved Partner signs in dealerships.

* Subject to status



Find out more at swiftholidayhomes.co.uk



Brochures



Layouts



Dealer



Social



Distribution Partners

Cumbria
Kendal Caravans
Kendal
Tel: 01539 823659
kendalcaravans.co.uk



Devon
Surf Bay Leisure
Winkleigh
Tel: 01837 680100
surfbayleisure.co.uk



Dorset
Surf Bay Leisure
Bridport
Tel: 01308 427444
surfbayleisure.co.uk

Durham
Ideal Caravans
Durham
Tel: 0191 378 0146
idealcaravans.co.uk

Hampshire
PM Leisure
Hayling Island
Tel: 023 9246 7722
pmleisure.co.uk

Lancashire
Westfield Caravans
Blackpool
Tel: 01253 301505
westfieldcaravans.co.uk

Lincolnshire
Seymours Caravans
Skegness
Tel: 01754 764270
seymourscaravans.co.uk

TLC Skegness
Skegness
Tel: 01754 875050
theleisurecompany.co.uk

Norfolk
McDonnell Caravans
Kings Lynn
Tel: 01553 636243
mcdonnellcaravans.co.uk

Parklands Leisure
Wells-next-the-Sea
Tel: 01328 710166
parklandsleisure.co.uk

Pioneer Caravans
Peterborough
Tel: 01733 222244
pioneercaravans.co.uk

Northumberland
Ideal Caravans
Adderstone
Tel: 0191 378 6615
idealcaravans.co.uk

Shropshire
Salop Leisure Ltd
Shrewsbury
Tel: 01743 282400
salopleisure.co.uk



Somerset
Surf Bay Leisure
Bream
Tel: 01278 751171
surfbayleisure.co.uk

Worcestershire
Salop Leisure
Worcester
Tel: 01299 878872
salopleisure.co.uk

Yorkshire
Bridlington
Caravan Centre
Bridlington
Tel: 01262 606777
bridlingtoncaravans.com



Yorkshire Holiday Homes
Wetherby
Tel: 01937 849128
yorkshirehh.co.uk

Ireland
Harry Farrell & Sons Ltd
Dublin
Tel: +353 1 4589410
harryfarrellsons.ie

Wallace Mobile Homes
Co Wexford
Tel: +353 51 511435
wallacemobilehomes.com

Burkes Caravans
Co Cork
Tel: +353 21 4646796
burkescaravans.com

Clancys Mobile Homes
Co Limerick
Tel: 353 85 8582793
clancysmobilehomes.ie

Scotland
Swalwell Holiday Group
Gatehouse of Fleet
Tel: 01556 506 200
swalwellholidaygroup.co.uk

Dee Valley Caravans
Aberdeen
Tel: 01330 811351
deevalleycaravans.co.uk

Livingston Swift Show Park
Edinburgh
swiftshowgrounds@swiftleisure.co.uk

Northern Ireland
Sandycove Holiday Homes
Donaghadee
Tel: 028 4275 8200
sandycove.co.uk

Hayes Caravans
Dungannon
Tel: 0288 7767575
hayescaravans.com



Wales
Blackhills Caravan
Sales
Gower
Tel: 01792 851221
blackhillscaravansales.co.uk



Lloyds Caravan & Lodge Sales
Towyn
Tel: 01745 832050
lloyds-caravans.co.uk

Salop Leisure
Machynlleth
Tel: 01654 705900
salopleisure.co.uk

Mon Caravans
Anglesey
Tel: 01248 711070
moncaravans.com



Blackhills Caravan
Sales
Tenby
Tel: 01834 818840
blackhillscaravansales.co.uk



Belgium
Caravancentrum Roels
Tel: +32 (0)9 369 20 26
caravancentrumroels.be

Germany
De-Bergjes
info@bergjes-ostsee.de
+49 (0) 4533 78 54947

Holland
De-Bergjes
+31 (0)475 495 079
info@bergjes.nl

Visit swiftholidayhomes.co.uk



Edition 2

This brochure does not constitute an offer by Swift Group Limited (Swift). Swift reserves the right to alter specifications and prices at any time as materials and conditions demand. Distributors and dealers sell Swift products on their own account and not as agents of Swift. Accordingly, they have no authority to bind Swift or to make any representation or undertaking whatsoever on behalf of Swift. Please note, within this brochure, concept imagery may be used and therefore final specifications may be subject to change. Please confirm with your supplying dealer. All props are for photographic purposes only and are not included in the specification. Models shown may be fitted with optional extras. Issued September 2024.

 **MANUFACTURED
IN BRITAIN**